



## 1007NT Caster Brace Update Pull-Type 10-Foot 09 Series No-Till Drills

- 1007NT-1575
- 1007NT-1906



*When you see this symbol, the subsequent instructions and warnings are serious - follow without exception. Your life and the lives of others depend on it!*

## General Information

These instructions explain how to install a Caster Brace Update. The brace reduces the potential for weldment damage if the drill is subject to extended periods of transport over unusually rough roads.

Great Plains recommends installing this update on all drills, regardless of projected transport.

These instructions apply to an installation of:

| Kit      | Kit Description            |
|----------|----------------------------|
| 151-168A | 1007 REAR CASTER BRACE KIT |

One kit updates one drill.

This kit is only for the 1007NT pull type 10-foot no-till drill with 07 Series openers, manufactured prior to mid-2009. The kit is not compatible with CP1000 drills, EW10 family drills or 3-point drills.

## Related Documents

Have the Operator Manual at hand for drill movements.  
150-290M Operator, 1007NT

Have the current Parts Manual at hand for parts ID.  
150-290P Parts, 1007NT

## Notations and Conventions

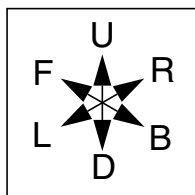

“Left” and “Right” are facing in the direction of machine travel. An orientation rose in the line art illustrations shows the directions of Left, Right, Front, Back, Up, Down.

### Call-Outs

- ① to ⑨ Single-digit callouts identify components in the currently referenced Figure. These numbers may be reused for different items from page to page.
- ⑪ to ⑮ Two-digit callouts in the range 11 to 15 reference new parts from the list on page 7.
- ⑤① to ⑤④ Two-digit callouts in the range 51 to 54 reference existing parts from the list on page 7

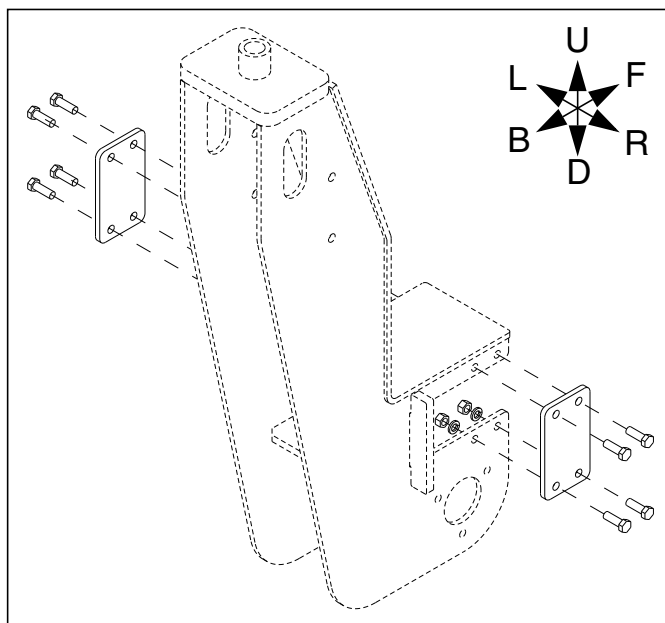

Figure 1  
Kit Parts (Solid Lines) 29712

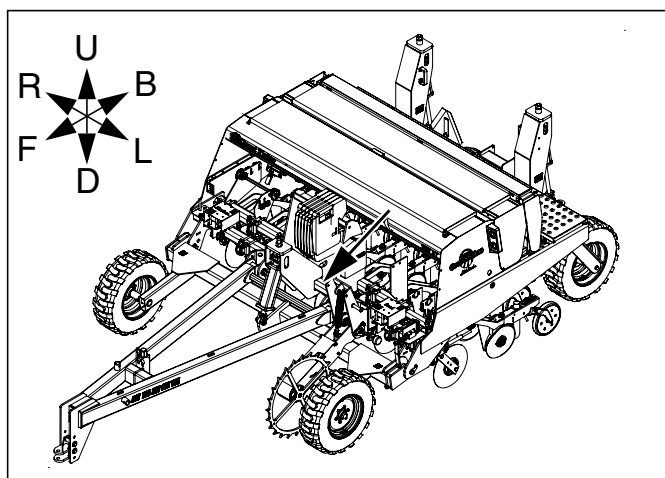

Figure 2  
1007NT Serial Number Location 28454

## Before You Start

### Compatibility

Refer to Figure 2 on page 1

1. Verify from the serial number plate that the drill is the model number (1007NT) compatible with this kit.
1. Check the gap where the caster weldments mount on the frame cross-tube. Newer drills already have a brace plate installed in gap ① and do not need this kit.

Refer to Figure 3

2. Clean the inside and outside surfaces of the general installation area.
3. Inspect the weld fillets at points ②, ③, ④ and ⑤, on both sides of and inside the weldment.

---

#### IMPORTANT !

If any welds are cracked, do not install the kit. Have your dealer contact Great Plains for further assistance.

4. Inspect the general condition of the caster weldment side plates. Perform a trial alignment of the brace plate, as per step 15 through step 20 on page 5. Do not mark the hole locations at this time.

---

#### IMPORTANT !

If the plate cannot lie flat against the weldment, or the hole locations would not meet the center-line requirement of step 14, do not install the kit. Have your dealer contact Great Plains for further assistance.

### Inventory

5. Make sure all parts are present (page 7).

### Comprehension

6. Review these instructions. Make sure the installers understand where each part or assembly is installed, and what tools are required for the task.

Note: Illustrations in this manual, based on the parts manuals for this family of drills, may show exploded views that are fully disassembled. Rely on the instructions for required disassembly and reassembly steps.

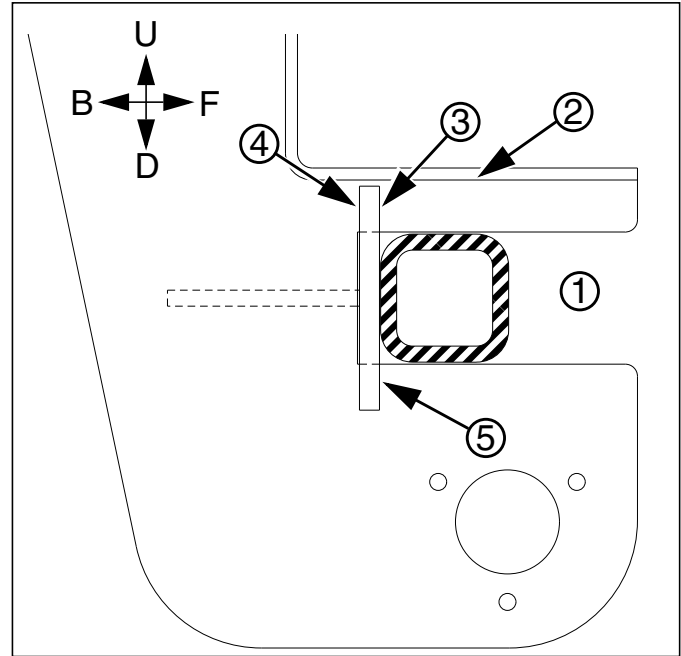
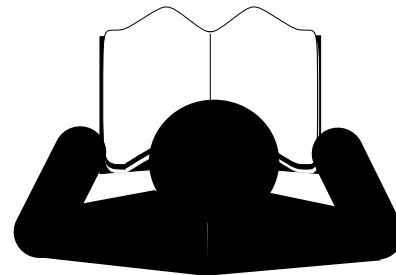

Figure 3  
Inspect Caster Weldment

29713



---

## Pre-Assembly Preparation

---

### Tools Required

- fire extinguisher (if grinding is required)
- Drill operator manual (see page 1)
- updated drill Parts Manual (see page 1)
- suitable tractor for raising implement
- basic hand tools, including:
  - center punch
  - drill
  - $1\frac{7}{32}$ in (13.5mm) drill bit
  - $\frac{3}{16}$ in (5mm) pilot drill bit
- fine-tip marker
- touch-up paint may be required, Great Plains spray can part number 821-001C, or use a green exterior enamel close to Pantone® 356C.

### Work Location

7. Move the implement to a location with:
  - adequate illumination;
  - clear surface beneath for recovery of any falling or dropped parts - if the surface is not clear, have a tarp or drop cloth available; and,
  - no flammable materials near or beneath the drill.

### Prepare Implement

8. Raise the drill.
9. Install transport locks.
10. Lower parking jack and unhitch.



#### ***Crushing Hazard***

*Do not loosen or remove the U-bolts that secure the caster weldments to the frame tube. If raised, the drill may fall. If lowered, the heavy caster weldments may topple.*



#### ***Possible Fire Hazard***

*Fitting of the brace plates may require grinding, which will produce sparks capable of starting a fire.*

This installation may be performed with the drill lowered, but access to the site is less convenient.

The tractor may be left hitched if preferred.

## Remove Walkboard

Removing the walkboard eases access to update sites.

Refer to *Figure 4*

11. Loosen the four (4) nuts:
  - ⑤4 803-014C NUT HEX 3/8-16 PLT that secure retainers:
  - ⑤1 119-032D 3-PT STEP RETAINER
12. Slide one end of the walkboard (one of):
  - ⑤2 119-296D 1006 WALKBOARD
  - ⑤2 119-303H 1006 SEED WALKBOARD WELDMENT
  - ⑤2 142-318D 3P1006NT FERTILIZER WALKBOARD

Toward drill center until clear of retainers. Slide in the opposite direction to clear retainers at other end. Lift walkboard off drill. Place the walkboard where no one will injure themselves on, or damage, the Slow Moving Vehicle reflector.

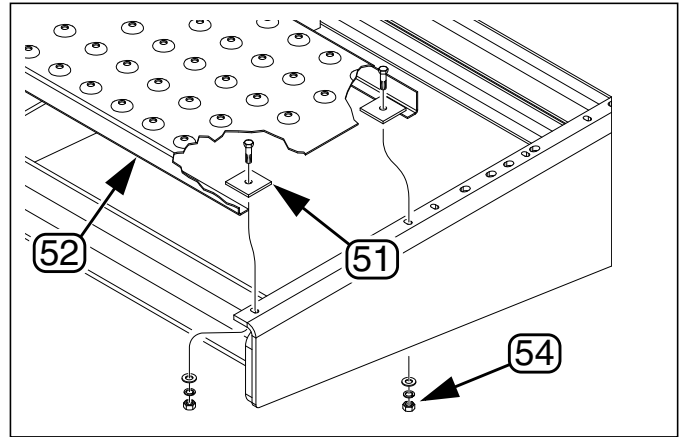

Figure 4  
Remove Walkboard

28386

## Mark Hole Locations

### Mark Hole Edge Center-Lines

Start with the right side of the right caster weldment.

Refer to *Figure 3*

13. On the outside faces of the caster weldment plates at each gap, mark lines parallel to the gap edge:
  - ⑥ distance:  $\frac{5}{8}$ in (0.625in, 15.9mm)

Mark from leading edge to tube.

### Check for Weldment Distortion

14. Near the weldment front, check the dimension ⑦ from center-line to center-line. The expected distance between the center-lines is:
  - $5\frac{1}{2}$ in (5.50in, 14.0cm)

#### IMPORTANT !

If, on any face of any weldment, dimension ⑦ is greater than:

$5\frac{3}{4}$ in (5.75in, 14.6cm)

do not install the kit. Have your dealer contact Great Plains for further assistance.

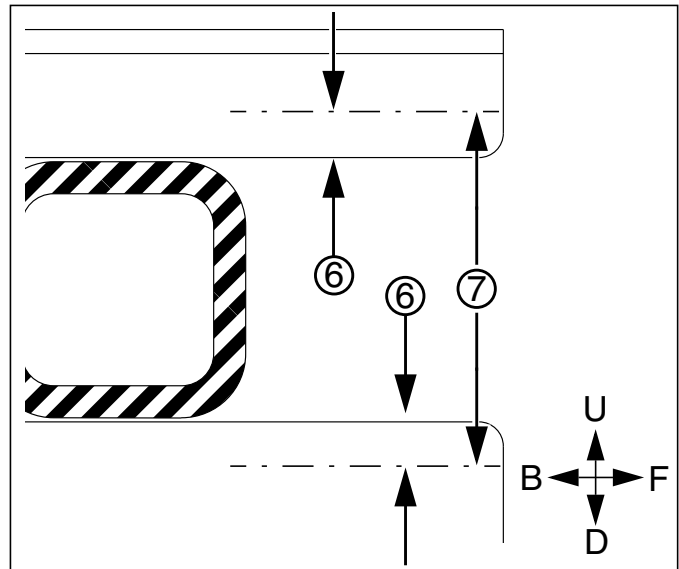

Figure 5  
Mark Center-Lines

29713

## Mark Holes

Refer to Figure 6

15. Select one new:
  - ⑫ 151-359D REAR CASTER BRACE PLATE
16. Position the brace plate ⑫ at the gap ①. Align the front edge of the plate ② with the front edge of the weldment side plates ③. If it is not possible to align the front edges, push the brace plate back against the tube ④.
17. Adjust the vertical position so that all four holes ⑤ are on the center-lines ⑦.
18. If the plate cannot be positioned high enough for the top holes to reach center-line, it may be necessary to grind off some of the weld fillet there.
19. Using the plate ⑫ as a template, mark all four holes. Use a center-punch to make a detent at each hole center (which may not be precisely on center-lines).
20. Repeat step 13 through step 19 for the left side of the weldment, and both sides of the left weldment.
21. If any grinding was necessary, sand and repaint the area prior to final assembly.

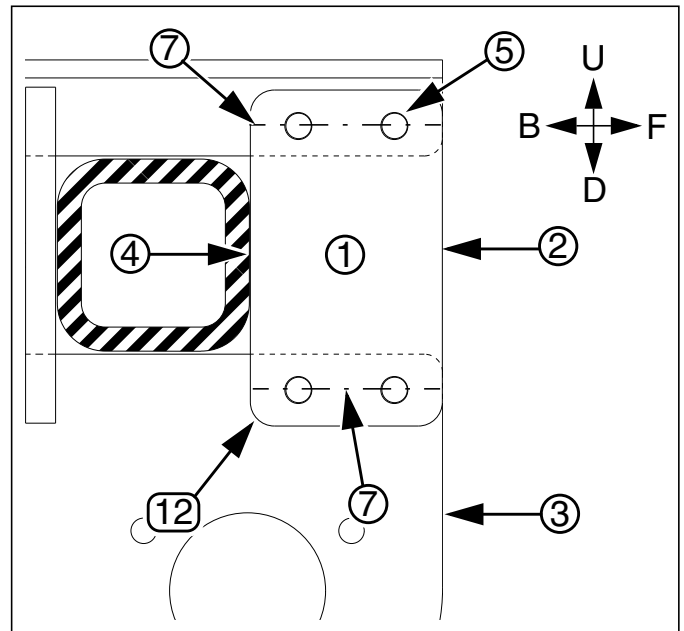

Figure 6  
Position a Brace

29714

## Drill Holes and Assemble

Refer to Figure 7

Start with the right side of the right caster weldment.

22. Using the pilot bit, drill a small hole at each of the 4 hole locations.
23. Using the final bit, drill the final hole at each location.
24. Select one new:
  - ⑫ 151-359D REAR CASTER BRACE PLATE
 and four sets new:
  - ⑬ 802-091C HHCS 1/2-13X1 1/2 GR5
  - ⑮ 804-015C WASHER LOCK SPRING 1/2 PLT
  - ⑭ 803-020C NUT HEX 1/2-13 PLT
25. Position the plate ⑫ at the outside of the weldment. From the outside, insert all four bolts ⑬. Secure with lock washers ⑮ and nuts ⑭ to torque spec: 76 ft-lbs (105 N-m)
26. Repeat step 22 through step 25 for the left side of the weldment, and both sides of the left weldment.

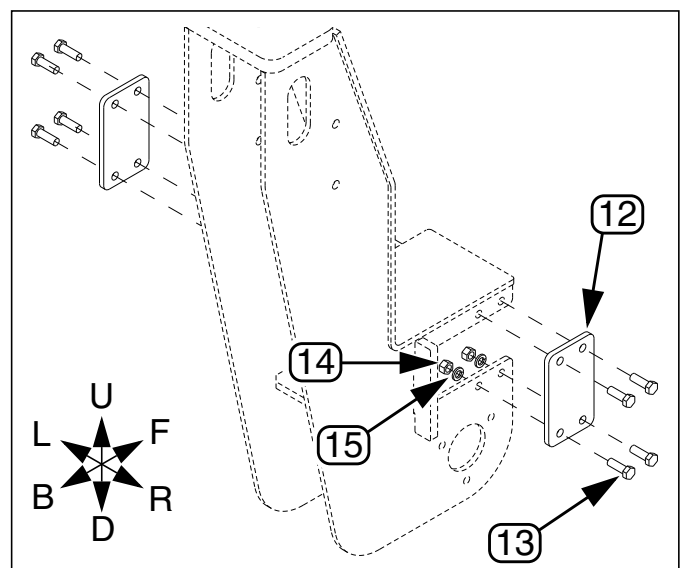

Figure 7  
Brace Installation

29712

## Closeout

### Re-Install Walkboard

*Refer to Figure 8*

27. Position walkboard (52), with SMV reflector to rear, so that one end is just inboard of the retainers (52).
28. Lift the retainers and slide the walkboard under them, and a few inches (10cm) past the side of the frame.
29. At the other side of the drill, lift the retainers at that end, and slide the walkboard under them. Center the walkboard between the frame sides.
30. Tighten nuts (54) to torque spec:  
31 ft-lbs (42 N-M)

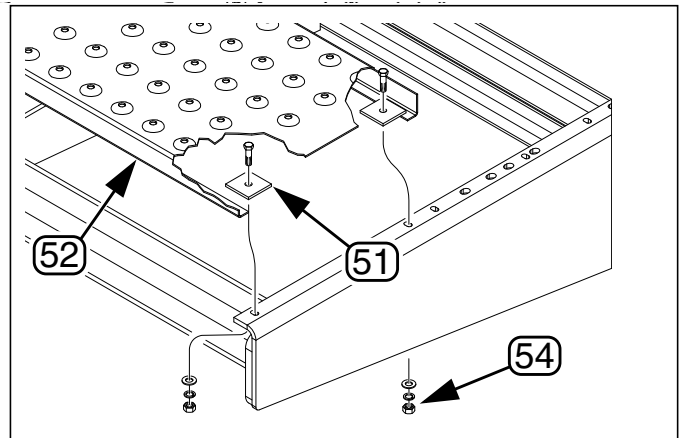

Figure 8  
Re-Install Walkboard

28386

## Appendix

### Part Lists

#### New Parts

The part call-out numbers in this list match all Figures in these installation instructions. Part descriptions match those in your updated Parts Manual.

Quantities are units ("ea").

#### Kit Contents

| Callout | Quantity | Part Number | Part Description             |
|---------|----------|-------------|------------------------------|
| 11      | 1        | 151-169M    | 1007 CASTER BRACE UPDATE MAN |
| 12      | 4        | 151-359D    | REAR CASTER BRACE PLATE      |
| 13      | 16       | 802-091C    | HHCS 1/2-13X1 1/2 GR5        |
| 14      | 16       | 803-020C    | NUT HEX 1/2-13 PLT           |
| 15      | 16       | 804-015C    | WASHER LOCK SPRING 1/2 PLT   |

#### Existing Parts Affected

The following existing parts are involved in the kit installation. The Disposition column indicates whether the part is left in place, moved or not re-used.

The part call-out numbers in the list matches all Figures in the installation instructions. The descriptions match those in your implement Parts manual.

| Callout | Part No.                         | Part Description  | Part Disposition          |
|---------|----------------------------------|---|---------------------------|
| 51      | 119-032D                         | 3-PT STEP RETAINER  | Removed and re-installed. |
| 52      | 119-296D<br>119-303H<br>142-318D | 1006 WALKBOARD<br>1006 SEED WALKBOARD WELDMENT<br>3P1006NT FERTILIZER WALKBOARD | Removed and re-installed. |
| 53      | 802-079C                         | HHCS 3/8-16X1 1/4 GR5   | Removed and re-installed. |
| 54      | 803-014C                         | NUT HEX 3/8-16 PLT  | Removed and re-installed. |

### Abbreviations

|          |                     |
|----------|---------------------|
| 1006     | Drill Model Number  |
| 1007     | Drill Model Number  |
| 3P, 3-PT | Three Point (hitch) |
| GR5      | Grade 5             |
| HEX      | Hexagonal           |

|      |                           |
|------|---------------------------|
| HHCS | Hex Head Cap Screw (Bolt) |
| MAN  | Manual                    |
| NT   | No Till                   |
| PLT  | Plated                    |
| X    | by                        |

**Great Plains Manufacturing, Inc.**

Corporate Office P.O. Box 5060  
Salina, Kansas 67402-5060 USA